

SI.134

Revolving handles

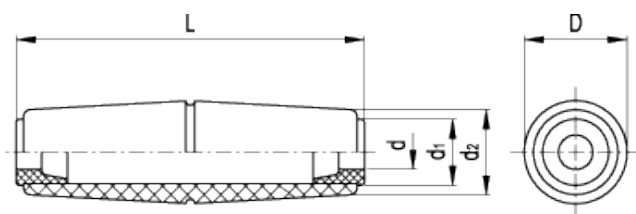

technical informations

Material

Phenolic based (PF) Duroplast. Resistant to solvents, oils, greases and other chemical agents.

Colour

Black, glossy finish with equatorial groove.

Assembly

Plain through hole with polyamide based (PA) technopolymer guide bosses in both ends.

Standard Elements		Main dimensions					Weight
Code	Description	L	D	d	d ₁	d ₂	g
55701	SI.134/105-6	105	29	6	18	23	52
55711	SI.134/105-7	105	29	7	18	23	52
55721	SI.134/105-8	105	29	8	18	23	51
55731	SI.134/105-10	105	29	10	18	23	50

ELESA and GANTER models all rights reserved in accordance with the law. Always mention the source when reproducing our drawings.

STANDARD MACHINE ELEMENTS WORLDWIDE